

Honing stone profiles

Manufacturing to customer drawing

The shape of a honing stone is standardized to ISO 525. Furthermore, these can be supplied with various profiles as illustrated; other profiles can be manufactured to customer drawing.

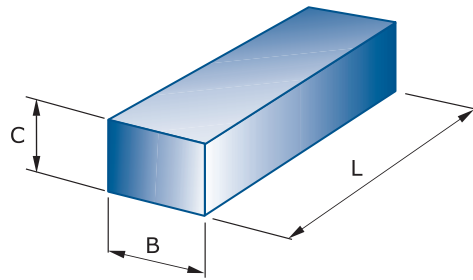

Honing stone Shape 5410
- $B \times C \times L$

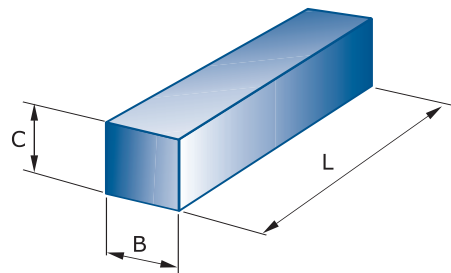

Honing stone Shape 5411
- $B \times C \times L$



Example of a honing stone profile:
(Shape 5410/6)

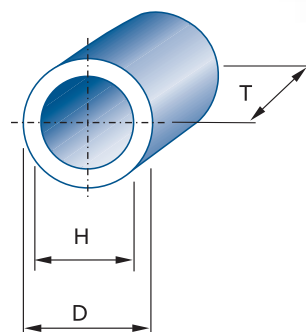

Honing stone Shape 5420
- $D \times T \times H$

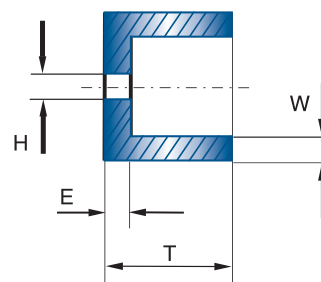
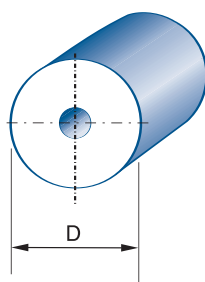

Honing stone Shape 5421
- $D \times T \times H - W/E$

Honing stone profiles

Common honing stone profiles

0



1



2



3



4



5



6



7



8



Special profiles for superfinishing

In addition to the illustrated profiles, there are a number of other shapes, which can be manufactured to drawing.

0



1



2



3

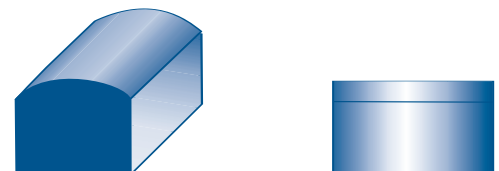

4



5



6

